

# ONE PIECE RESIDENTIAL SEPTIC TANK

ITEM #A-11 FOR REGULAR (A-11HD FOR HEAVY DUTY)

WEIGHT - 6,640 LBS

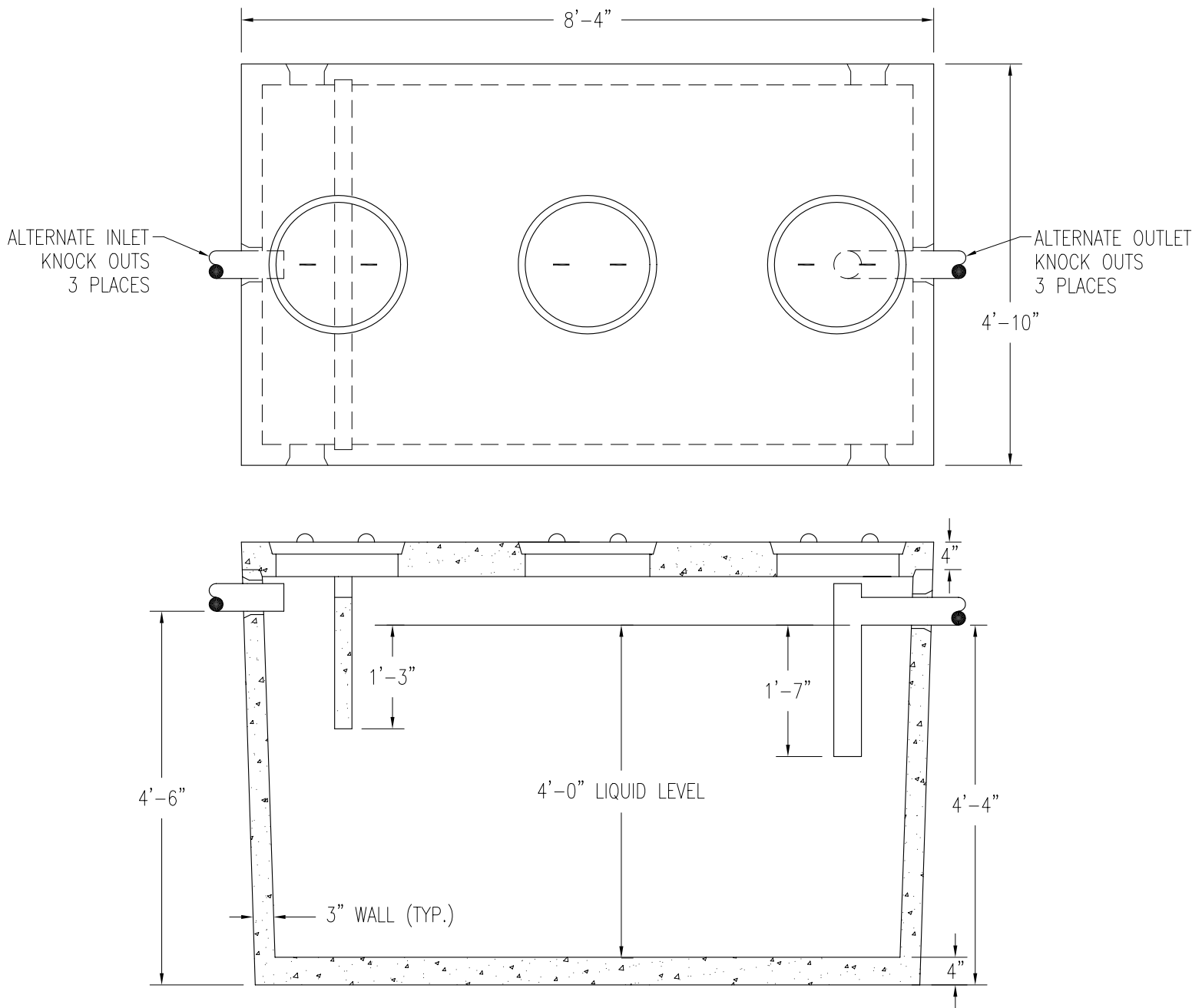

## DESIGN NOTES:

- 1 - CONCRETE 4000 PSI AT 28 DAYS.
- 2 - OUTLET Baffle PROVIDED SEPARATLY WITH THE TANK.
- 3 - COVER REINFORCED WITH 6X6/10X10 W.W.M.
- 4 - HEAVY DUTY COVER TO BE 6" THICK AND REINFORCED WITH 1/2" REBAR ON 6" CENTERS EACH WAY.
- 5 - SEPTIC TANK IS A MONOLITHIC POUR TO PROVIDE A ONE PIECE SEAMLESS POUR.
- 6 - MASTIC SEALANT PROVIDED TO SEAL COVER TO TANK.